

NOVA LUCE

9209212

1

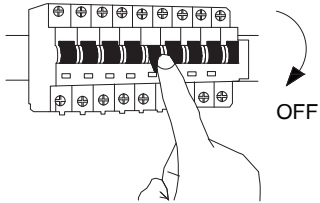

Turn off the general switch

2

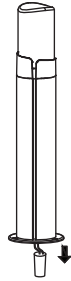

Dismantle parts to expose wires

3

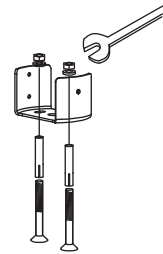

Drill holes apply plastic anchors
Tie up screws to make it stable

4

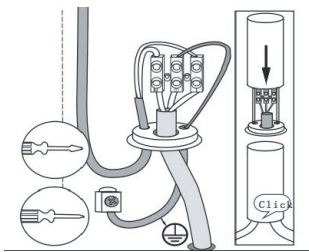

Connect wires & apply the screws

5

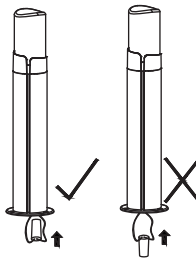

Install properly

6

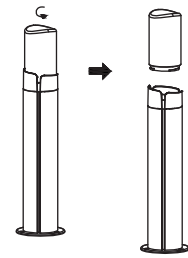

Untie the cap by rotate

7

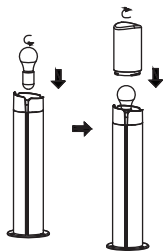

Inserts bulb &
Fix the cap into place by rotatings

8

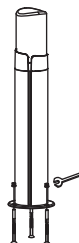

Tie up side screws
to make it stable

9

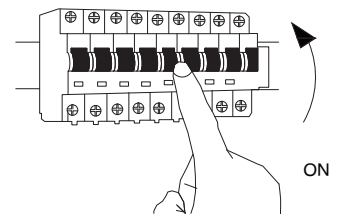

Turn off the general switch

