

1

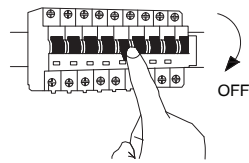

Turn off the general switch

A.

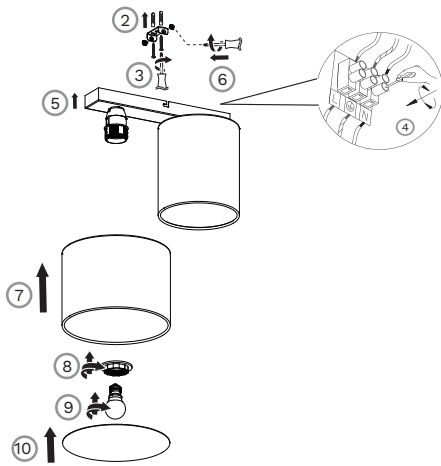

B.

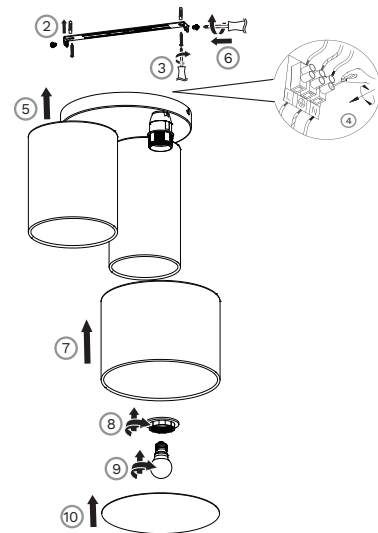

2. Make holes & apply plastic anchors
3. Tie up screws
4. Connect wires
5. Place the luminaire onto place

6. Tie up side screws to make it stable
7. Insert the cap by rotate
8. Tie up the ring by rotate
9. Insert the bulb/bulbs by rotate
10. Tie up the end cap into place

11

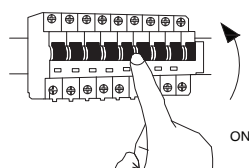

Turn on the general switch

